

AMENDED RECORD OF SURVEY

(SURVEY M166-38)
LOCATED IN THE S 1/2 OF SECTION 7
AND THE
E 1/2 OF SECTION 17
TOWNSHIP 29 SOUTH, RANGE 4 WEST, WILLAMETTE MERIDIAN
DOUGLAS COUNTY, OREGON

FILED
DATE: 5-24-2017 BY: J.C.
THIS SURVEY CONSISTS OF:
MAP FILE: 29-A-D
DOUGLAS COUNTY
REGISTERED PROFESSIONAL LAND SURVEYOR

LEGEND

- 5/8" x 24" REBAR WITH 1 1/4" YELLOW PLASTIC CAP FROM SURVEY M166-38A-D VERIFIED OR RESET THIS AMENDED SURVEY. (KLEIN & ASSOC. LS 59002)
- ⊗ 5/8" x 24" REBAR WITH 1 1/4" YELLOW PLASTIC CAP FROM SURVEY M166-38A-D VERIFIED OR RESET THIS AMENDED SURVEY. (DYER PARTNER LS 2340)
- 5/8" x 24" REBAR WITH 1 1/4" YELLOW PLASTIC CAP SURVEY M166-38A-D VERIFIED OR RESET THIS AMENDED SURVEY. (KITZ 1853LS)
- ⊙ FOUND MONUMENT AS NOTED (SEE CORNER NOTES)
- COMPUTED POINT, NOT MONUMENTED
- ⊠ FOUND QUARTER CORNER SEE CORNER NOTES
- ⊞ FOUND SECTION CORNER SEE CORNER NOTES
- ⊞ COMPUTED QUARTER CORNER
- ⊞ COMPUTED SECTION CORNER
- ① POINT NUMBER
- {XXX.XX} GROUND DISTANCE
- {XXX.XX} RECORD DISTANCE PER REFERENCED SURVEY
- R1 REFERENCED SURVEY
- PROPOSED ALIGNMENT
- TEMPORARY CONSTRUCTION EASEMENT
- TEMPORARY WORK AREA
- POWER TRANSMISSION LINE

SURVEYOR'S CERTIFICATE

I, RICHARD R. KITZ BEING DULY SWORN AS A PROFESSIONAL LAND SURVEYOR IN THE STATE OF OREGON DO HEREBY CERTIFY THAT THIS MAP CORRECTLY REPRESENTS A SURVEY CONDUCTED UNDER MY DIRECT SUPERVISION IN CONFORMANCE WITH THE REQUIREMENTS OF THE SURVEY RECORDING LAW, AS ESTABLISHED BY ORS CHAPTER 209, AND HAVE SET THE PROPER MONUMENTS AS REFERENCED IN THE LEGEND BY MY REGISTRATION NUMBER AND SEAL.

FURTHERMORE, I APPROVE THE LOCATION OF THE MONUMENTS AS DEPICTED ON THIS SURVEY DRAWING TO BE IN THEIR PROPER LOCATION.

Richard R. Kitz
RICHARD R. KITZ PLS 1853
Expires 6-30-2017



SURVEYOR'S CERTIFICATE

I, DOUGLAS A. POPHAM BEING DULY SWORN AS A PROFESSIONAL LAND SURVEYOR IN THE STATE OF OREGON, ALSO BEING A CERTIFIED FEDERAL SURVEYOR, DO HEREBY CERTIFY THAT THIS MAP CORRECTLY REPRESENTS A SURVEY THAT I HAVE REVIEWED AND VERIFIED. THIS SURVEY CONFORMS WITH THE REQUIREMENTS OF THE STATE OF OREGON SURVEY RECORDING LAW, AS ESTABLISHED BY ORS CHAPTER 209.

FURTHERMORE, I APPROVE THE DESCRIPTIONS, DIMENSIONS AND LOCATIONS OF THE RECOVERED MONUMENTS AS DEPICTED HEREON.

Douglas A. Popham
DOUGLAS A. POPHAM PLS 2877
CFEDS 1245

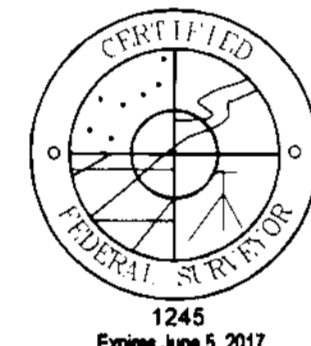
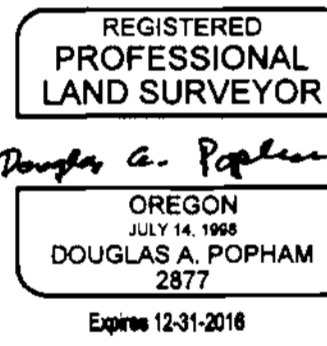

SURVEYOR'S CERTIFICATE

I, JAMES M. KLEIN BEING DULY SWORN AS A PROFESSIONAL LAND SURVEYOR IN THE STATE OF OREGON DO HEREBY CERTIFY THAT THIS MAP CORRECTLY REPRESENTS A SURVEY CONDUCTED UNDER MY DIRECT SUPERVISION IN CONFORMANCE WITH THE REQUIREMENTS OF THE SURVEY RECORDING LAW, AS ESTABLISHED BY ORS CHAPTER 209, AND HAVE SET THE PROPER MONUMENTS AS REFERENCED IN THE LEGEND BY MY REGISTRATION NUMBER AND SEAL.

FURTHERMORE, I APPROVE THE LOCATION OF THE MONUMENTS AS DEPICTED ON THIS SURVEY DRAWING TO BE IN THEIR PROPER LOCATION.

James M. Klein
JAMES M. KLEIN PLS 59002

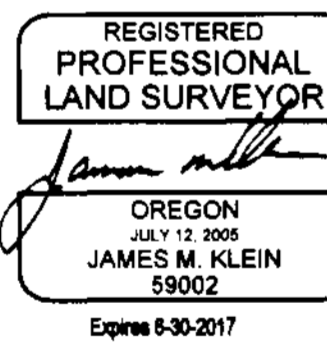

SURVEYOR'S CERTIFICATE

I, MICHAEL W. ERICKSON BEING DULY SWORN AS A PROFESSIONAL LAND SURVEYOR IN THE STATE OF OREGON DO HEREBY CERTIFY THAT THIS MAP CORRECTLY REPRESENTS A SURVEY CONDUCTED UNDER MY DIRECT SUPERVISION IN CONFORMANCE WITH THE REQUIREMENTS OF THE SURVEY RECORDING LAW, AS ESTABLISHED BY ORS CHAPTER 209, AND HAVE SET THE PROPER MONUMENTS AS REFERENCED IN THE LEGEND BY MY REGISTRATION NUMBER AND SEAL.

FURTHERMORE, I APPROVE THE LOCATION OF THE MONUMENTS AS DEPICTED ON THIS SURVEY DRAWING TO BE IN THEIR PROPER LOCATION.

Michael W. Erickson
MICHAEL W. ERICKSON PLS 2340

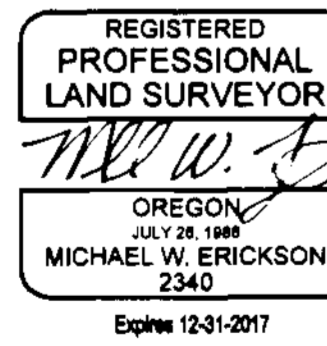

NARRATIVE

THE PURPOSE OF THIS SURVEY IS TO MONUMENT THE TEMPORARY CONSTRUCTION CORRIDOR FOR THE WILLIAMS PACIFIC CONNECTOR GAS LINE WITHIN THE BLM LANDS, LOCATED IN SECTIONS 7 AND 17, TOWNSHIP 29 SOUTH, RANGE 4 WEST OF THE WILLAMETTE MERIDIAN.

THE PUBLIC LAND SURVEY SYSTEM MONUMENTS WERE FOUND AND TIED BY KLEIN & ASSOCIATES, UNDER THE DIRECT SUPERVISION OF JAMES M. KLEIN.

THE PUBLIC LAND MONUMENTS AND BREAKDOWN WAS VERIFIED BY DOUG POPHAM A CERTIFIED FEDERAL SURVEYOR WITH PRIMM LAND SURVEYING.

THE TEMPORARY CONSTRUCTION EASEMENT WAS SURVEYED AND MONUMENTED BY THE DYER PARTNERSHIP, UNDER THE DIRECT SUPERVISION OF MICHAEL W. ERICKSON, KLEIN & ASSOCIATES INC, UNDER THE DIRECT SUPERVISION OF JAMES M. KLEIN AND EASTSIDE SURVEYING UNDER THE DIRECT SUPERVISION OF RICHARD R. KITZ, SEE LEGEND SHOWING THE MONUMENT SYMBOLS.

THE INTERSECTION OF THE TEMPORARY CONSTRUCTION EASEMENT AND THE FEDERAL LANDS WERE MONUMENTED BY KLEIN & ASSOCIATES, UNDER THE DIRECT SUPERVISION OF JAMES M. KLEIN. SEE LEGEND SHOWING THE MONUMENT SYMBOLS.

SHEET INDEX:

- SHEET 1 = COVER PAGE TOWNSHIP OVERVIEW
- SHEET 2 = SECTION 7
- SHEET 3 = SECTION 17
- SHEET 4 = SECTION 17

REFERENCES:

- R1) CORRECTIVE DEPENDENT RESURVEY, DEPENDENT RESURVEY AND SUBDIVISION OF SECTIONS APPROVED MARCH 5, 1997. C.S. #1997A
- R2) DEPENDENT RESURVEY AND SUBDIVISION OF SECTIONS APPROVED APRIL 20, 1990. C.S. #1990
- R3) LAND PARTITION FILED AS DOCUMENT NO. 2007-0087
- R4) RECORD OF SURVEY NO. M157-36
- R5) RECORD OF SURVEY NO. M166-38A-D

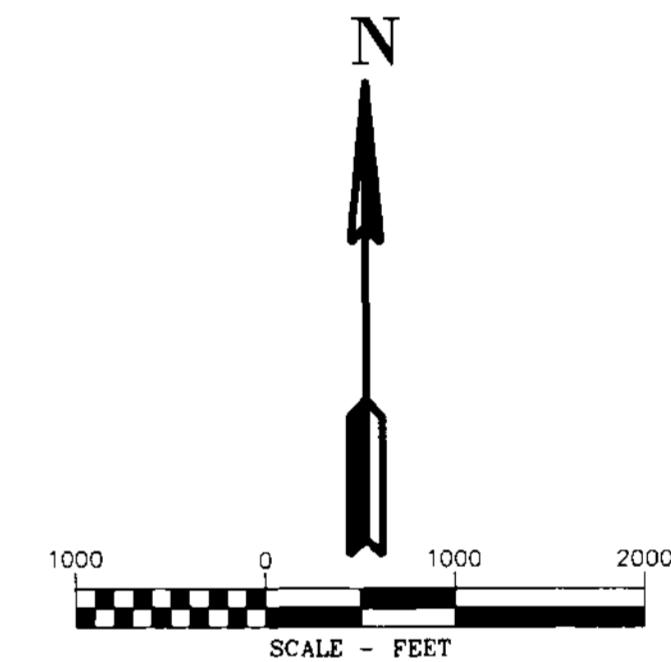
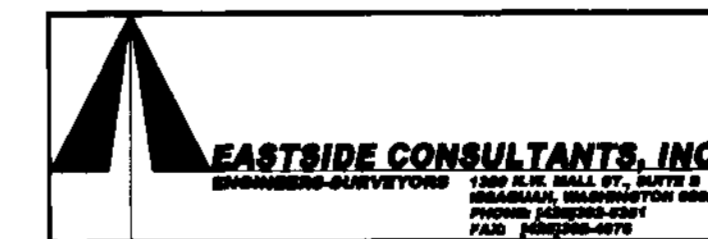

BASIS OF BEARINGS NOTE:

THE PROJECT DATUM IS BASED ON PREVIOUSLY ESTABLISHED PROJECT CONTROL. THE DATUM IS VERY CLOSE BUT NOT EXACTLY OREGON SOUTH ZONE 3602.

THE PROJECT BEARINGS MATCH THE OREGON SOUTH ZONE 3602 BEARINGS IN US SURVEY FEET.

NOTE:

DISTANCES ARE IN US SURVEY FEET. MEAN MERIDIAN CONVERGENCE ANGLE = -1°5'16"

AMENDED NOTE

THIS SURVEY IS INTENDED TO AMEND SURVEY NO. M166-38 FILED ON AUGUST 12, 2015.

PAGES 3 AND 4 OF SAID SURVEY NO. M166-38 DEPICTS MONUMENTS SET BY MICHAEL ERICKSON OF THE DYER PARTNERSHIP ENGINEERS & PLANNERS, INC.

IT HAS BEEN DISCOVERED THAT JAMES KLEIN AND ASSOCIATES INC. ESTABLISHED MONUMENTS ON PAGE 3 OF THIS SURVEY AND RICHARD R. KITZ OF EASTSIDE CONSULTANTS INC. ESTABLISHED MONUMENTS SHOWN ON PAGES 3 AND 4 OF THIS SURVEY.

ALSO A PORTION OF THE TEMPORARY WORK AREA WITHIN SECTION 17, DEPICTED ON PAGE 3 OF 4 OF SURVEY NO. M166-38 HAS BEEN CHANGED.

ALL OTHER ITEMS AS SHOWN ON SURVEY NO. M166-38 ARE UNCHANGED.

WILLAMETTE MERIDIAN
DOUGLAS COUNTY, OREGON

T.29S., R.04W
07
17

SURVEY PERFORMED FOR:
WILLIAMS
DATE: NOVEMBER 10, 2016
PROJECT: 14-02-05 DRAFT: GD, LS
FILE: RS-29S-04W.DWG

SCALE FACTOR NOTE

THE DISTANCES SHOWN ON THIS SURVEY ARE GRID DISTANCES UNLESS NOTED. THE COMBINED SCALE FACTOR = 0.999854039 TO CONVERT FROM GRID TO GROUND MULTIPLY THE DISTANCE BY 1.000145962

EXAMPLE: 300.00' GRID DISTANCE
300.00' x 1.000145962 = 300.04' GROUND DISTANCE



PACIFIC CONNECTOR GAS PIPELINE PROJECT
PACIFIC CONNECTOR GAS PIPELINE, LP
RECORD OF SURVEY
SECTION OVERVIEW
TOWNSHIP 29 SOUTH, RANGE 4 WEST, W.M.
DOUGLAS COUNTY, OREGON

DRAWN BY: LJS	DATE: 11-10-16	ISSUED FOR BID:	SCALE: 1" = 1000'
CHECKED BY:	DATE:	ISSUED FOR CONSTRUCTION:	
APPROVED BY:	DATE:	DRAWING NUMBER:	SHEET 1 OF 4