

COUNTY SURVEYORS FILE DATA
DO NOT REMOVE FROM OFFICE

NE 1/4 & SE 1/4 SEC. 26, T. 31 S., R. 5 W., W.M.

FILED

Date: 10/30/2000 By: JLP
This survey consists of: 16 Pgs.
Map: M135-71-J
Narrative: _____
Corner Ppt: _____

DOUGLAS COUNTY
SURVEYOR

LEGEND	
▲	SET MONUMENT
○	FOUND MONUMENT
- - - -	EDGE OF PAVEMENT
====	METAL MEDIAN BARRIER

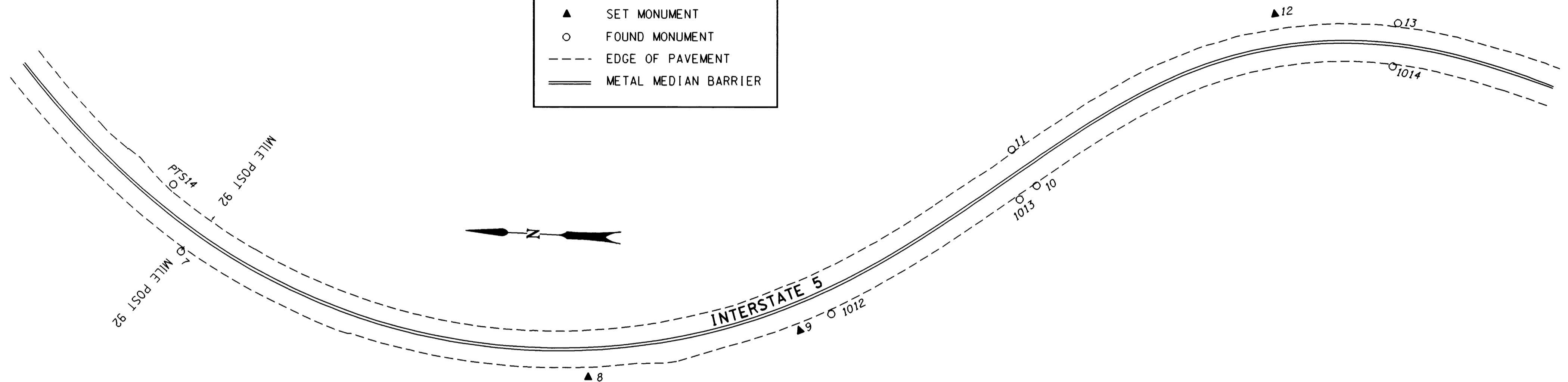

POINT ID	LDP NORTHING	LDP EASTING	DESCRIPTION
7	135271.920	384592.075	FOUND 5/8" IRON ROD W/A 1 1/2" ALUM. CAP STAMPED "OREG. STATE HWY. DIV." FLUSH W/ SURFACE SET IN CONC. IN GOOD CONDITION. PADDLE BOARD NEARBY MARKED "SHRP PSC LN 384+66.86", 76.0 FT. RT. (DRG. NO. 8B-31-12)
8	134979.690	384517.100	SET 16 mm X 762 mm IRON REBAR W/A 38 mm BRASS CAP STAMPED "ODOT CONTROL 8" FLUSH W/ SURFACE.
9	134831.717	384557.588	SET 16 mm X 762 mm IRON REBAR W/A 38 mm BRASS CAP STAMPED "ODOT CONTROL 9" 30 mm ABOVE SURFACE.
10	134668.872	384667.412	FOUND 5/8" IRON ROD W/ 1 1/2" ALUM. CAP STAMPED "OREG. STATE HWY. DEPT." 350 mm BELOW SURFACE SET IN CONC. IN GOOD CONDITION. PADDLE BOARD NEARBY MARKED "SHRP POT LN 405+27.69 P.S. LS 405+27.69, 42.0 RT.", 30 FT. RT. OF LS. (DRG. *8B-31-12)
11	134687.696	384692.144	FOUND 5/8" IRON ROD W/A 1 1/2" ALUM. CAP STAMPED "OREG. STATE HWY. DEPT." 200 mm BELOW SURFACE SET IN CONC. IN GOOD CONDITION. STATION LN 405+27.69 P.O.T., LS 405+27.69 P.S. 42.0 FT. LT., 25 FT. LT. OF LN. (DRG. *8B-31-12)
12	134506.142	384798.191	SET 16 mm X 460 mm IRON REBAR W/A 38 mm BRASS CAP STAMPED "ODOT CONTROL 12" 20 mm BELOW SURFACE.
13	134418.430	384795.100	FOUND 5/8" IRON ROD W/A 1 1/2" ALUM. CAP STAMPED "OREG. STATE HWY. DIV." 250 mm BELOW SURFACE SET IN CONC. IN GOOD CONDITION. STA. LS 414+47.27 P.C.S., 67 FT. LT.
1012	134809.822	384569.637	FOUND 5/8" IRON ROD W/A 1 1/2" ALUM. CAP STAMPED "OREG. STATE HWY. DEPT." 20 mm BELOW SURFACE SET IN CONC. IN GOOD CONDITION. STATION LN 399+77.06 P.C.S., 76.0 FT. RT. (DRG. *8B-31-12)
1013	134680.408	384657.063	FOUND 5/8" IRON ROD W/A 1 1/2" ALUM. CAP STAMPED "OREG. STATE HWY. DEPT." 150 mm BELOW SURFACE SET IN CONC. IN GOOD CONDITION. PADDLE BOARD NEARBY MARKED "SHRP P.T. LN 404+77.06" 76.0 FT. RT. (DRG. *8B-31-12)
1014	134420.718	384764.145	FOUND 5/8" IRON ROD W/A 1 1/2" ALUM. CAP STAMPED "OREG. STATE HWY. DEPT." SET IN CONC. 130 mm BELOW SURFACE IN GOOD CONDITION. PADDLE BOARD NEARBY MARKED "SHRP P.C.S. LS 414+47.27" 30.0 FT. RT. (DRG. *8B-31-12)
PTS14	135279.561	384639.215	FOUND 2 1/8" BRASS DISK SET IN N.W. CORNER OF CONC. DRAIN BASIN STAMPED "DOUGLAS CO. SURVEYORS OFFICE 1975 PTS-14" FLUSH W/ CONC. IN GOOD CONDITION.

REGISTERED
PROFESSIONAL
LAND SURVEYOR
Christine V. Blawie
OREGON
JULY 19, 1984
CHRISTINE V. BLAWIE
2000
EXPIRES: DEC. 31, 2001

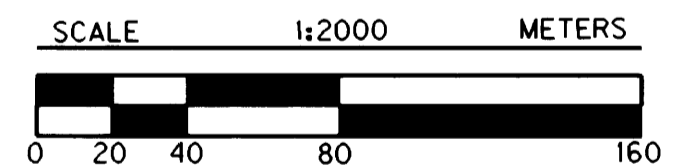

1 METER = 3937 U.S. FEET / 1200
TO CONVERT A METRIC DISTANCE DIVIDE BY 0.30480061

OREGON DEPARTMENT OF TRANSPORTATION
HORIZONTAL CONTROL
AND RECOVERY MAP
CANYONVILLE - AZALEA SECTION
INTERSTATE 5
DOUGLAS COUNTY
3500 STEWART PARKWAY, SUITE 140
ROSEBURG, OREGON 97470

OCTOBER 26, 2000
PROJECT KEY *10832

SHEET 10 OF 16

ST. HWY. 15-010J

MAP FILE M135-71J

MAP FILE M135-71J